



Effective 3/22/2025

LOCAL BUS ROUTE

MAJOR DESTINATIONS:

- St Paul
Westgate Station
Raymond Ave Station
Cretin Ave
University of St Thomas
Grand Ave
Macalester College
Downtown St Paul
East St Paul
3rd St
Sun Ray Shopping Center

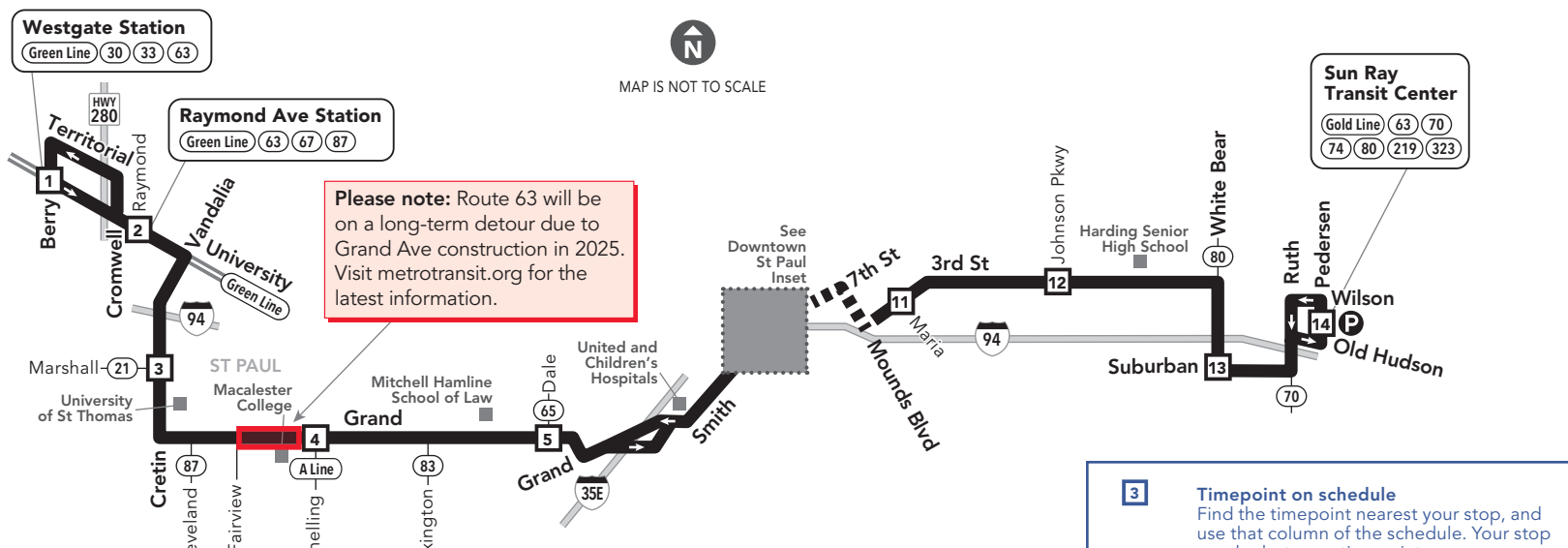

Please note: Route 63 will be on a long-term detour due to Grand Ave construction in 2025. Visit metrotransit.org for the latest information.

St Paul Downtown Zone

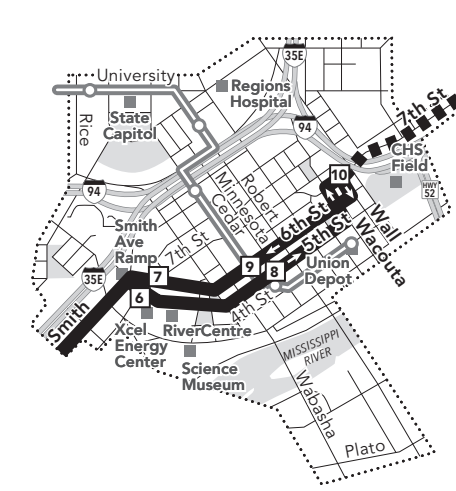

Please note: Kellogg Blvd bridge will be closed for reconstruction through 2027. Buses will travel non-stop between downtown St Paul and 3rd St on detour.

- Timepoint on schedule
Regular Route
Non-Stop Service
METRO Line and Stations
Connecting Routes
Park & Ride Lot

Go-To Card Retail Locations
A refillable Go-To Card is the most convenient way to travel by transit!

Park & Ride Locations
Park free at these lots while you commute. No overnight parking.

All buses and trains have bike racks so you can bring your bicycle along.

Metro Transit Mobile App
Now you can plan your trip, see arrival information for bus and trains and buy transit tickets all on the go!

Trip Planner form with fields for To, From, and a Go button.

How to Ride

- 1. Arrive 5 minutes before the schedule or NexTrip says your trip will depart.
2. Watch for your bus number.
3. Pay your fare as you board, except for Pay Exit routes.
4. Pull the cord above the window about 1 block before your stop to signal the driver.

METRO LINES

- 1. Arrive 5 minutes before the schedule or NexTrip says your trip will depart.
2. Pay BEFORE you board—touch your card to a reader on the platform or buy a ticket from the machine.
3. Push the blue button to open doors (trains only).
4. METRO LRT lines stop at every station. METRO BRT lines stop at stations on demand and when customers are present.

MAKING CONNECTIONS

Transfer between buses and METRO lines for up to 2 1/2 hours with your fare.

Those who try to ride without paying may be subject to a fine.

Metro Transit
612-373-3333 • metrotransit.org

Table with fare information: Local Bus & METRO Fares, Express Bus Fares, Reduced Fares.

Reduced Fares
See rates above. To receive a reduced fare:
Bus - Please tell the bus driver before you pay your fare if you qualify for a reduced fare.

Qualifying ID
Seniors (65+): Show a Minnesota driver's license/state ID with a Senior/ endorsement.
Medicare card holders: Show a Medicare card along with a MN driver's license/state ID.

Fare Cards/Passes
Buy a variety of passes at Metro Transit service centers, retail outlets or online. Or buy tickets via Metro Transit's Mobile App.

Fareboxes
Buses accept U.S. bills and coins. Change is not available.

Transfers
All fares (excluding the Downtown Zone) include a transfer. This gives you unlimited rides on buses and METRO lines for 2 1/2 hours.

Information: 612-373-3333

Metro Transit is the one place for all your transportation information.

Transit Information

Hours:
Monday - Friday: 6:30 am - 8:00 pm
Saturday: 8:00 am - 4:30 pm
Sunday & Holidays: Closed

NexTrip

Real-time departure information.
Customer Relations / Lost & Found
570 6th Ave N, Minneapolis, MN 55411

Hours: Mon. - Fri., 8:00 am - 4:30 pm
Closed weekends and holidays

Go-To Cards: Check your balance and add value.

711 Minnesota Relay (hearing impaired)

metrotransit.org

- NexTrip: Real-time departure times
Trip planner and interactive map
Printable schedules
Go-To Cards: buy, add value, check balance
Chat with a transit expert
Bike and carpooling resources

Text for Transit Info

Text transit questions or trip plan requests to 612-444-1161. Available only during TIC hours of operation.

Monday - Friday

EASTBOUND from Westgate Station to Sun Ray Transit Center via downtown St Paul

Table with 14 columns for route numbers and 24 rows of departure times for Eastbound service.

Monday - Friday

WESTBOUND from Sun Ray Transit Center to Westgate Station via downtown St Paul

Table with 14 columns for route numbers and 24 rows of departure times for Westbound service.

Not all stops are shown on this timetable.

Use the timepoints on the map and the schedule to estimate the arrival of your bus. For details, call Transit Information or explore our interactive map and trip planning tools at metrotransit.org.

Saturday

EASTBOUND from Westgate Station to Sun Ray Transit Center via downtown St Paul

Table with 14 columns (route number & letter, Westgate Station, Raymond Ave Station, Crestin Ave and Marshall Ave, Grand Ave and Snelling Ave, Grand Ave and Dale St, 5th St and 7th St, ARRIVE 5th St and Minnesota St, DEPART 5th St and Minnesota St, 7th St and Wall St, 3rd St and Maria Ave, 3rd St and Johnson Pkwy, Suburban Ave and White Bear Ave, Sun Ray Transit Center) and 14 rows of departure times for AM and PM.

Saturday

WESTBOUND from Sun Ray Transit Center to Westgate Station via downtown St Paul

Table with 14 columns (route number & letter, Sun Ray Transit Center, Suburban Ave and White Bear Ave, 3rd St and Johnson Pkwy, 3rd St and Maria Ave, Wall St and 7th St, ARRIVE 6th St and Cedar St, DEPART 6th St and Cedar St, 6th St and 7th St, Grand Ave and Dale St, Grand Ave and Snelling Ave, Crestin Ave and Marshall Ave, Raymond Ave Station, Westgate Station) and 14 rows of departure times for AM and PM.

Sunday & Holiday

EASTBOUND from Westgate Station to Sun Ray Transit Center via downtown St Paul

Table with 14 columns (route number & letter, Westgate Station, Raymond Ave Station, Crestin Ave and Marshall Ave, Grand Ave and Snelling Ave, Grand Ave and Dale St, 5th St and 7th St, ARRIVE 5th St and Minnesota St, DEPART 5th St and Minnesota St, 7th St and Wall St, 3rd St and Maria Ave, 3rd St and Johnson Pkwy, Suburban Ave and White Bear Ave, Sun Ray Transit Center) and 14 rows of departure times for AM and PM.

Sunday & Holiday

WESTBOUND from Sun Ray Transit Center to Westgate Station via downtown St Paul

Table with 14 columns (route number & letter, Sun Ray Transit Center, Suburban Ave and White Bear Ave, 3rd St and Johnson Pkwy, 3rd St and Maria Ave, Wall St and 7th St, ARRIVE 6th St and Cedar St, DEPART 6th St and Cedar St, 6th St and 7th St, Grand Ave and Dale St, Grand Ave and Snelling Ave, Crestin Ave and Marshall Ave, Raymond Ave Station, Westgate Station) and 14 rows of departure times for AM and PM.

Holiday service operates on New Year's Day, Memorial Day, Independence Day, Labor Day, Thanksgiving and Christmas. Service may be reduced on days before or after Independence Day, Thanksgiving, Christmas or New Year's Day. Look for details at metrotransit.org prior to these holidays.

This schedule is subject to change. Traffic and weather conditions may delay buses. Get updates on service during severe winter weather at metrotransit.org/snow.

This document is available in alternative formats to individuals with disabilities. Call 612-349-7365 or visit metrotransit.org.